

# Guide to Your E-scooter's Registration Mark and Identification Mark

You have successfully registered your e-scooter.

The Registration Mark for your e-scooter is on the right.

Your e-scooter's registration number is printed on the Registration Mark.

## What you need to do:

1. Affix the Registration Mark to your e-scooter; and
2. Make a separate Identification Mark bearing the registration number and affix it to your e-scooter (see overleaf for instructions).

Please ensure you have affixed both the Registration Mark and Identification Mark to your e-scooter within 14 calendar days from the date of registration. It is an offence to use an e-scooter on public paths without the Registration or Identification Mark.

## Registration Mark

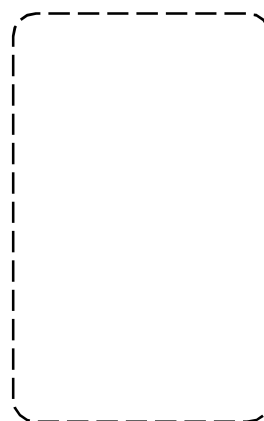

## Where to affix your Registration Mark:

Your Registration Mark must be affixed on the integral (i.e. non-detachable) stem of the e-scooter. Find a smooth surface and where possible, affix the Registration Mark to the front, and if not possible, on either side of the stem of the e-scooter. The Registration Mark must be affixed upright and must not be blocked from view at all times.

Please refer to illustration 1 on the suggested location to affix the Registration Mark.

## How to affix your Registration Mark:

### Surface Preparation

Make sure the area where you are affixing the Registration Mark is clean, dry and free of oil and dust.

### Application Procedure



1. Partially peel off the liner from the top and fold the liner to expose the adhesive surface of the Registration Mark by about 1cm.



2. Position and align the Registration Mark upright on the application area without allowing the adhesive surface to touch the e-scooter.



3. Once in position, press down the adhesive surface to the application area with your thumb and hold it there.



4. With your thumb holding the top of the Registration Mark in place, peel the liner downwards slowly. At the same time, slide your thumb downwards firmly to press down the adhesive surface.

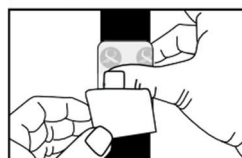

5. Press down the rest of the Registration Mark. Make sure the entire surface, especially the edges, are firmly attached to the application area.

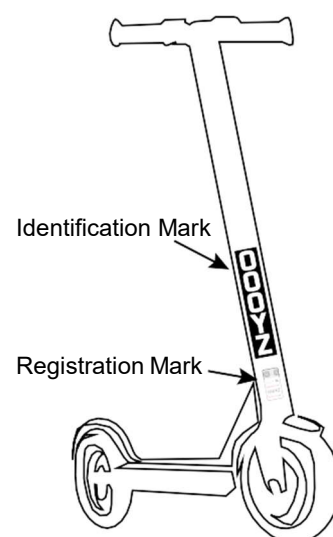

Illustration 1:  
Suggested locations to affix the Registration and Identification Marks.

### Caution:

**Do not detach the Registration Mark to re-position it once the adhesive touches the application area. Detaching it will damage the Registration Mark.**

## Identification Mark

You need to make an Identification Mark bearing the registration number according to specifications and affix it to your registered e-scooter. The Identification Mark can be in the form of a self-adhesive sticker. Such stickers can be made at any sign craft shop. You can find a list of sign craft shops on [www.onemotoring.com.sg/escooter](http://www.onemotoring.com.sg/escooter).

### Where to affix your Identification Mark:

Your Identification Mark must be affixed on the integral (i.e. non-detachable) stem of the e-scooter. Find a smooth surface and where possible, affix the Identification Mark on the front, and if not possible, on either side of the stem of the e-scooter. The Identification Mark must be affixed upright and must not be blocked from view at all times.

Please refer to illustration 1 on the suggested location to affix the Identification Mark. You can find more information on the specifications of the Identification Mark on [www.onemotoring.com.sg/escooter](http://www.onemotoring.com.sg/escooter).

### Specifications of Identification Mark:

- Black characters against a yellow background  
or
- White characters against a black background

#### Characters

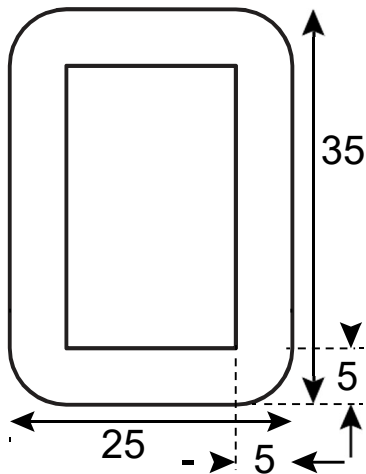

#### Vertical Configuration



#### Note:

All dimensions are in mm.

Illustrations not drawn to scale.